



台灣精品 2017  
TAIWAN EXCELLENCE



# New Power Saving Planet Gear Lopper



Extension Handle can be option.



Authorised Distributor



No.5/1426, Ragavendra Layout, Dharapuram Road,  
Udumalpet, Tiruppur, Tamil Nadu – 642 126  
Email : sstraders2023@outlook.com  
Mobile : +91 89035 66444, 63795 96953



# 01

## LOPPER



**BEST**

**Bypass Planet Gear Lopper**  
12701H

**38mm**



**FEATURE**

High carbon alloy steel blade for long-lasting sharpness

**1.16 kg**

**71cm**

**BEST**

**Gear Action Bypass Lopper**  
125013 - Steel Tube  
125018 - Alumin Tube

**42mm**



**FEATURE**

High carbon alloy steel blade for long-lasting sharpness

**1.0 kg**

**75cm**

**BEST**

**Gear Action Hook Anvil Lopper**  
105013 - Steel Tube  
105018 - Alumin Tube

**42mm**



**FEATURE**

High carbon alloy steel blade for long-lasting sharpness

**1.14 kg**

**76cm**

**BEST**

**Mini Gear Action Bypass Lopper**  
125023 - Steel Tube  
125028 - Alumin Tube

**28mm**



**FEATURE**

High carbon alloy steel blade for long-lasting sharpness

**0.66 kg**

**54.5cm**

**GOOD**

**Bypass Lopper**  
3203

**30mm**



**FEATURE**

Fully heated S50C carbon steel blade

**0.73 kg**

**61cm**

# 02

## HEDGE SHEARS



**BEST**

**Wavy Telescopic Hedge Shears**  
23100H



**FEATURE**

S50C carbon steel blades

**1.42 kg**

**66~86cm**

**BEST**

**Wavy Telescopic Hedge Shears**  
23002E



**FEATURE**

S50C carbon steel blades

**0.86 kg**

**66~86cm**

**GOOD**

**Straight Hedge Shears**  
3303



**FEATURE**

S50C carbon steel blades

**0.82 kg**

**52cm**

**GRASS SHEAR**

**90° Degree Grass Shears**  
41101Z



**90° Head rotates**

**FEATURE**

S50C carbon steel blades

**0.38 kg**

**33cm**

**SHARPENER**

**Sharpener**  
68009



**FEATURE**

Tungsten steel for sharpening material

**0.04 kg**

**12cm**

# 03 PRUNING SHEARS & SNIPS



**PRO**

**Drop Forged Bypass Pruner**  
32801B

**18mm**



**FEATURE**

Forged high carbon alloy steel blade for durability and strength

**0.28 kg**

← 20cm →

**PRO**

**Drop Forged Bypass Pruner**  
3860

**18mm**



**FEATURE**

Forged high carbon alloy steel blade for durability and strength

**0.28 kg**

← 20cm →

**BEST**

**Anvil Pruner**  
13101Z

**16mm**



**FEATURE**

Fully heated SK5 high carbon steel blade

**0.33 kg**

← 20cm →

**BETTER**

**Bypass Pruner**  
22389

**16mm**



**FEATURE**

Fully heated SK5 high carbon steel blade

**0.2 kg**

← 20cm →

**BETTER**

**Bypass Pruner**  
32003Z

**14mm**



**FEATURE**

Fully heated SK5 high carbon steel blade

**0.25 kg**

← 20cm →

**GOOD**

**Bypass Pruner**  
3828

**15mm**



**FEATURE**

Fully heated SK5 high carbon steel blade

**0.28 kg**

← 21cm →

**SNIPS**

**Stainless Straight Blade Snips**  
33003Z/235H2Z

**15mm**



**FEATURE**

Fully heated SK5 high carbon steel blade

**0.14 kg**

← 19cm →

**SNIPS**

**Stainless Curved Blade Fruit Snips**  
33004Z-1



**15mm**



**FEATURE**

Fully heated SK5 high carbon steel blade

**0.14 kg**

← 19cm →

# 04 TREE PRUNER



**PRO**

**Telescopic Cut And Hold Pruner**  
071A-L

**14mm**

**1 kg**

← 175~300cm →

**FEATURE**

Fully heated SK5 high carbon steel blade



**B**

**Bypass Tree Pruner (Metal Set)**  
2812



**25mm**

**0.63 kg**

← 31cm →

**FEATURE**

Fully heated SK5 high carbon steel blade

**3.5m Telescopic Fiber Glass Pole With Metal Holder (2 Staes)**



**1.44 kg**

← 350cm →

# 05 PRUNING SAWS



**Curved Saw With 3-Edge Grinding Teeth**

31119



0.35 kg

33cm



**Folding Saw With 3-Edge Grinding Teeth**

32009



0.15 kg

16cm



**Pruning Saw With Hook (Available With Telescopic Pole)**

26101K1



0.47 kg

33cm



**Pruning Saw (Available With Telescopic Pole)**

26102K2



0.3 kg

33cm



**Machete**  
31019



0.35 kg

45cm



**Machete**  
680029



0.44 kg

45cm

## ACCESSORIES



50507/51507/52507/53507 CULTIVATING TOLLS



13131Z HAND GRAFTING TOOL



H-210BG FOLDING SAW

F 350 BG PRUNING SAW



RH 330B SPRING SAW

## INSTRUCTION MANUAL

### CAREFUL USE

Do not twist the tool while in use, it may damage the upper or lower blade, please see the instruction as below.

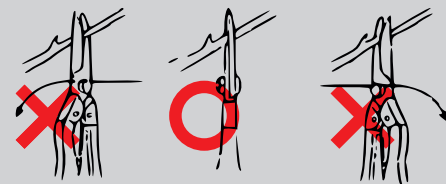

### PRUNING CUTS

Recommended Slope cut 45°angle, facing away from the bud to ensure water runs off, and would not damage the buds, please see the instruction as below.

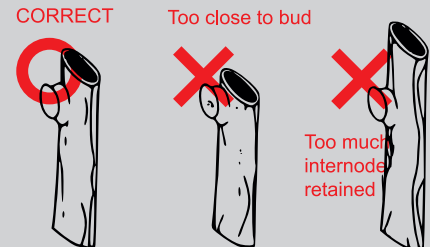

### MAINTENANCE

In order to maintain the tools in good condition and shelf life, cleaning all the debris after use, apply oil on the blade and store in a dry area.

### SAFETY GUIDELINES

Prevent eyes injury, wear eyes protection at work.

Prevent fingers injury, keep a distance and clear view while cutting the branches or vine.

Prevent foot injury, shoes or boots must be wear while doing pruning job.

Do not keep the tool inside the pocket, recommended to wear a scabbard.

Keep away from children, store the tool in the cupboard or higher ground.

### Authorised Distributor :



5/1426, Ragavendra Layout, Dharapuram Road, Udumalpet - 642 126

Ph: +91 89035 66444, 63795 96953

email: sstraders2023@outlook.com